

PV 6.22 FRM10X40 STBLANK (306 121)

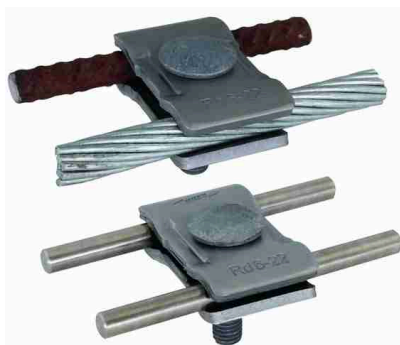
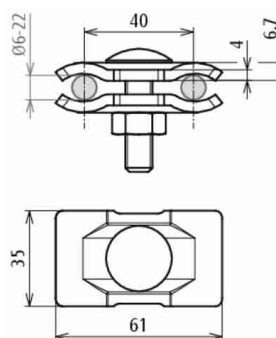

Figure without obligation



Til forbindelse af to parallelle ledere med en skrue.

Arrangement:



Type artikelnr.	PV 6.22 FRM10X40 STBLANK 306 121
Materiale (klemme)	St/blank
Klemmeområde (rund / rund)	6-22 / 6-22 mm
Skrue	⬆ M10 x 40 mm
Materiale (skrue / møtrik)	St/tZn
Lynstrømsbæreevne (10/350 µs)	50 kA *)
Standard	DIN EN 62561-1
Kortslutningsstrøm (AC 50 Hz / DC) (1 s; ≤ 300 °C)	6,1 kA
Materialetykkelse	4 mm
Vægt	161 g
Toldpositionsnummer (Kombinerede Nomenklatur EU)	85359000
GTIN	4013364284920
PU	50 Pakkestørrelse

*) for detaljer se prøvecertifikat

We reserve the right to introduce changes in performance, configuration and technology, dimensions, weights and materials in the course of technical progress. The figures are shown without obligation.